

Gresham Crossing

Redefining the simple life ...



Lot #33
Doug Perry Builders

\$485,900

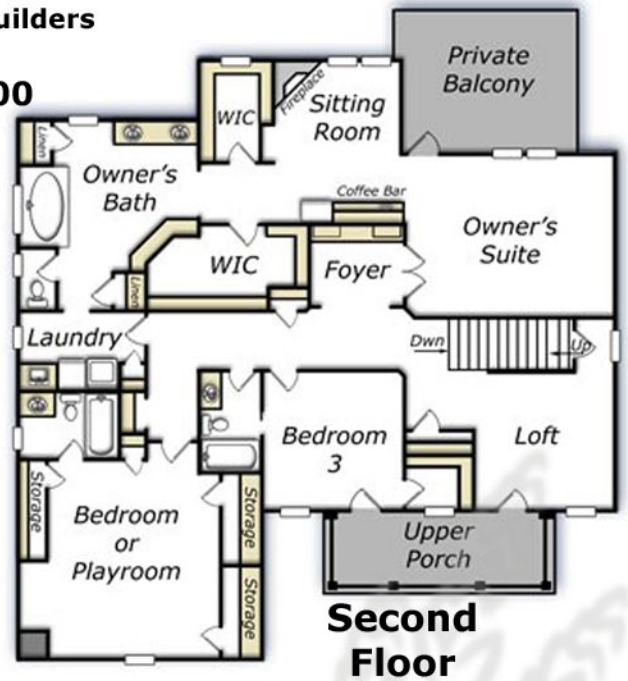
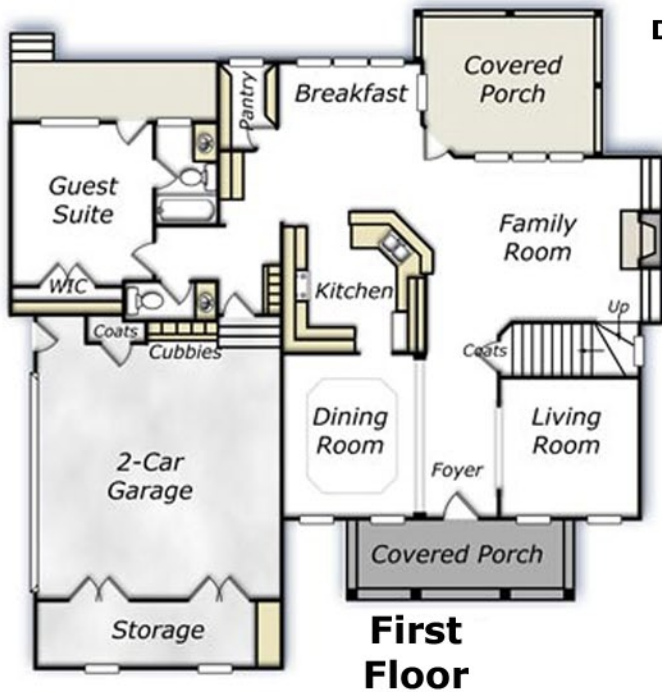

- 3585 sq. ft., 439 sq. ft. covered porches, 699 sq. ft. decks
- Majestic double front porch with 10" columns
- Trey ceiling in dining room
- Elegant arched doorways in the 1st floor common areas
- Stone fireplace, raised hearth and built-in bookshelves
- Second floor Owner's Suite with private balcony, and sitting room with corner fireplace

- Mud entry with seated cubbie storage
- Custom cabinets, granite countertops, tile back splash
- Downstairs guest suite with access to deck
- Walk-up attic access
- 2-Car garage with large storage
- Landscape lighting in the front of the home

Developed by:

www.GreshamCrossing.com

Sales by:



For more information contact:

Gayla Strickland

252-431-6252 (office) 252-430-9046 (mobile) gayla@inet4u.com (email)



*All information deemed reliable but not guaranteed.