

Gresham Crossing

Redefining the simple life ...



4300 S. Greg Allen Way

Lot #32

Buildmaster Custom Homes

MLS # 992944

~~**\$365,000**~~

\$299,900

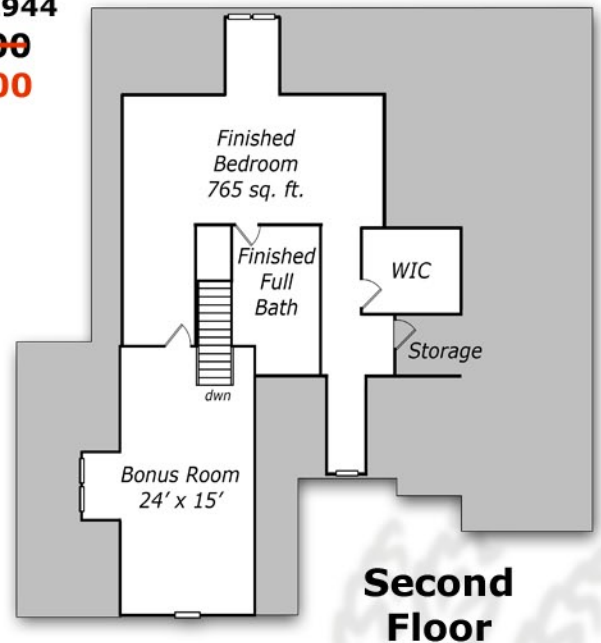
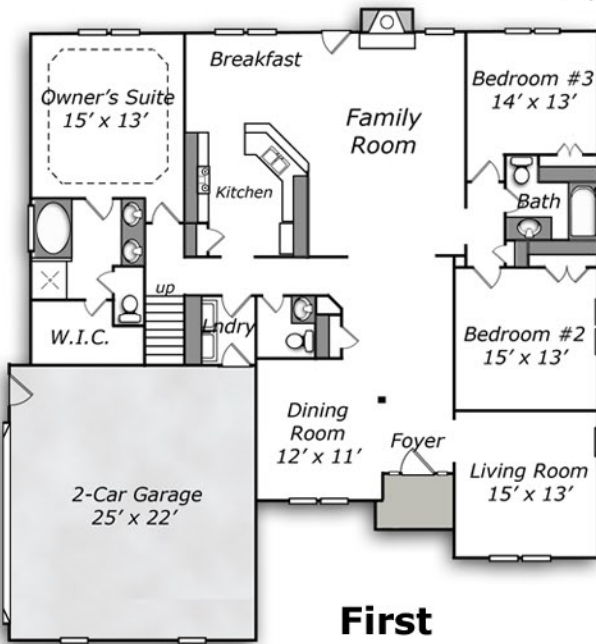

- 3165 sq. ft, exquisite view of pond
- Beautiful stone and brick front accents
- Hardwood floors in main living areas
- Two piece moldings, chairrail
- Stone faced fireplace with custom mantle in family room
- Second floor bonus room and storage area

- Majestic second floor bedroom suite w/ view of pond
- Custom cherry finished cabinets w/under lighting, granite countertops, tile back splash
- Master bath w/jetted tub, tile shower & tile flooring
- Large rear deck with forged iron balusters
- Finished garage w/extra parking pad

Developed by:

www.GreshamCrossing.com

Sales by:



For more information contact:

Gayla Strickland

252-431-6252 (office) 252-430-9046 (mobile) gayla@inet4u.com (email)

**COLDWELL
BANKER**

Advantage

*All information deemed reliable but not guaranteed.