

Gresham Crossing

Redefining the simple life ...



43007 S. Greg Allen Way

Lot #30
Daniel Construction, Inc.

MLS # 983287

\$269,000

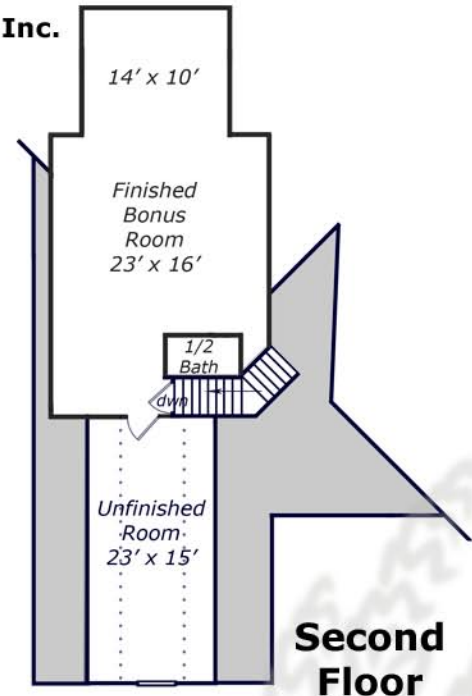
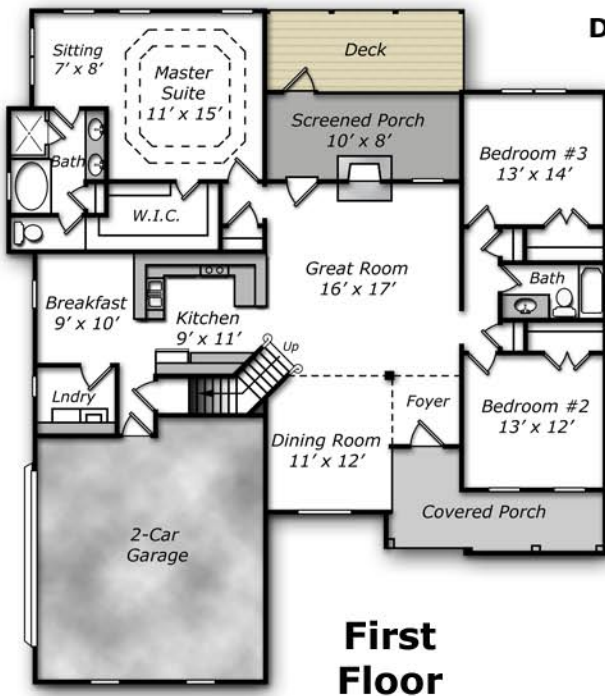

- 2555 square feet plus 340 sq.ft attic
- Beautiful brick and shake accented home
- Cathedral ceiling in family room
- 9' ceilings throughout the first floor
- Hardwoods in main living areas
- Granite kitchen countertops

- Ceramic tile baths and laundry room
- Large second floor bonus room wired for surround sound, half bath plus walk-in storage room
- Finished side entry double garage
- Rear screened porch and deck

Developed by:

www.GreshamCrossing.com

Sales by:



For more information contact:

Gayla Strickland

252-431-6252 (office) 252-430-9046 (mobile) gayla@inet4u.com (email)

*All information deemed reliable but not guaranteed.

